

BL 7

corner angle, ST-BS 81 Maintenance of function - Standard support structures

Wall bracket for fixing vertical ladder STU-BS 81 to the wall.

The product can be used for fire protection. For technical parameters, see National Technical Test Certificates (abPs).

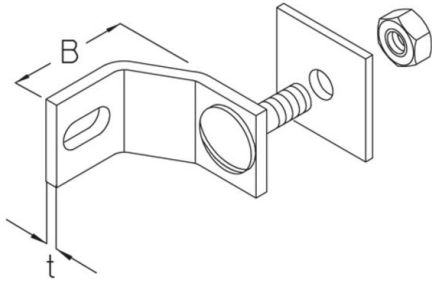

Hot-dip galvanized, according to BS 729 (DIN EN ISO 1461)

| Product | H | B | t | G |
|---------|-------|-------|---------|--------|
| BL 7F | 50 mm | 65 mm | 5,00 mm | 0,3 kg |

H: height
B: width
t: material thickness
G: weight

DETAILS / APPLICATIONS

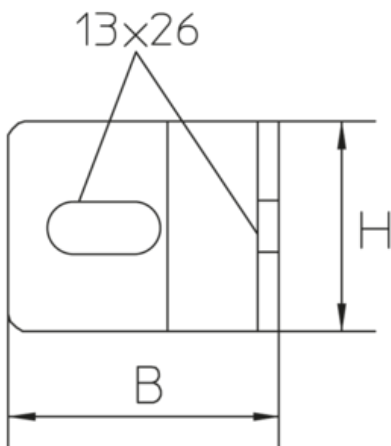



OPTIONAL ACCESSORIES

SD

