

**SKLC**  
clamp strap

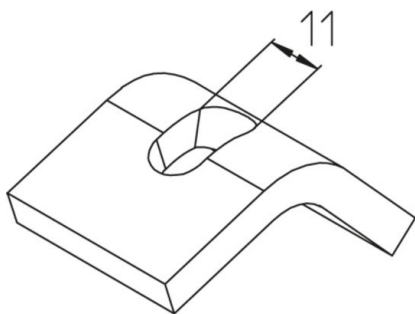

Hot-dip galvanized, according to BS 729 (DIN EN ISO 1461)

Product	k	P <sub>max</sub>	G
SKLC-HDG	5-25 mm	5 kN	0,16 kg

Stainless steel, according to ASTM 31 Ti / AISI 316 L, BS 320S17 / BS 316S11

Product	k	P <sub>max</sub>	G
SKLC-316	5-25 mm	5 kN	0,16 kg

**k**: clamping range  
**P<sub>max</sub>**: Maximum load  
**G**: weight

