

## UEBDSM VP WD

stainless steel heavy-duty tube cover unit, triple, angular, plane

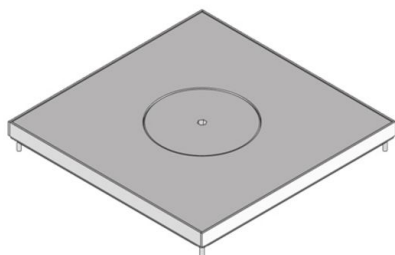

Square cartridge made of stainless steel, flat surface, blasted. As a cartridge installation frame with heavy-duty tube outlet cartridge, screwed-on aluminium board mounting set, rubber seal and mounting screws. For the assembly on levelling units. To accommodate up to 3 mounting boxes equipped with up to 9 suspension bracket installation devices or 12 installation devices of 45x45 mm. Suitable for rooms with wet-cleaned floor covers. Designed for high traffic loads.

Please mind the technical information in chapter planning.



material	cartridge and frame: 2mm high-grade steel V2A, sub construction: sheet steel galvanized
type of assembly	Assembly on floor box UBDHB / rough concrete ceiling
application area	wet floor cleaning
protection class	in use IP 22 / not in use IP 54
norm	according to DIN EN 50085
permits	according to VDE / TÜV
loading	including inspection stamp Ø 130 mm: 20 kN

### Stainless steel, according to ASTM 304 / BS 304 S 3

Product	H	H <sub>min</sub>	B	L	E	P <sub>max</sub>	IP <sub>n</sub>	mounting box	installation units/outlet socket	G
UEBDSM 15-VP8-WD	19 mm	85 mm	258 mm	258 mm	261 x 261 mm	20 kN	IP 54	triple UG in UNE	9x coultter clip or 12x 45x45mm	6,72 kg
incl.:						rubber seal, square Phillips screw				
1x UGD3-V 2										
1x UKS M4X16E										

**H:** height  
**H<sub>min</sub>:** Minimum installation height



**B:** width

**L:** length

**E:** fitting dimension

**P<sub>max</sub>:** Maximum load

**IP<sub>n</sub>:** IP protection level in unused condition

**mounting box:** Maximum number of installable device casings.

**installation units/outlet socket:** Maximum number of installable installation devices

**G:** weight

## DETAILS / APPLICATIONS

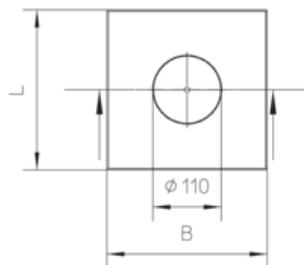
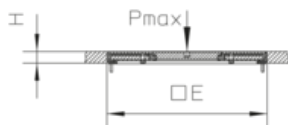

wet-cleaned

