

A 2

montageprofiel 30x15 mm, niet geperforeerd

montageprofiel 50x31x3,25 mm, zonder perforatie, sleufmaat 22 mm

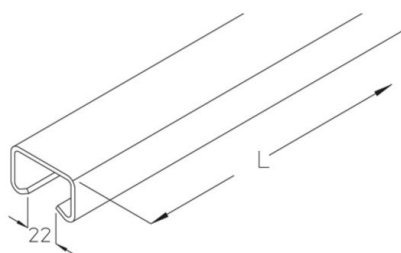

Walsblank

Product	H	B	L	t	G
A 2-30B	31 mm	50 mm	3000 mm	3,25 mm	8,8 kg
A 2-60B	31 mm	50 mm	6000 mm	3,25 mm	17,6 kg

Thermisch verzinkt volgens BS 729 (DIN EN ISO 1461)

Product	H	B	L	t	G
A 2-30F	31 mm	50 mm	3000 mm	3,25 mm	9,4 kg
A 2-60F	31 mm	50 mm	6000 mm	3,25 mm	18,8 kg

H: hoogte
B: breedte
L: lengte
t: materiaaldikte
G: gewicht

DETAILS / TOEPASSINGEN



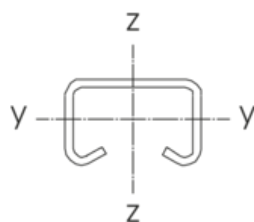
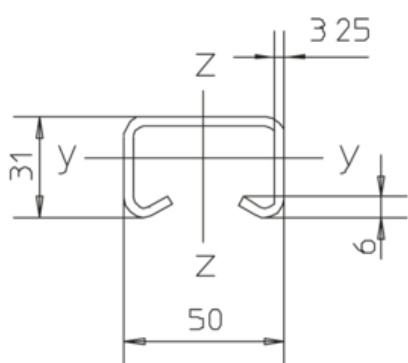

$$\begin{aligned}W_y &= 2.45 \text{ cm}^3 \\W_z &= 5.42 \text{ cm}^3 \\I_y &= 4.33 \text{ cm}^4 \\I_z &= 13.54 \text{ cm}^4\end{aligned}$$

OPTIONELE TOEBEHOREN

HS22, SKS H

