

## KHA 9

montageprofiel 40x25 mm, geperforeerd

montageprofiel 40x25x2,75 mm, geperforeerd 11x24, sleufmaat 18 mm

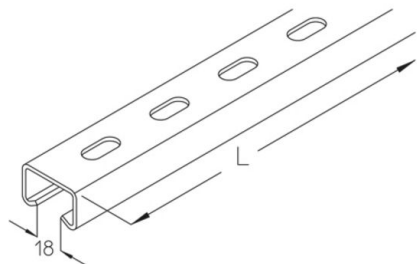

Thermisch verzinkt volgens BS 729 (DIN EN ISO 1461)

Product	H	B	L	t	G
KHA 9-02F	25 mm	39,5 mm	200 mm	2,75 mm	0,4 kg
KHA 9-03F	25 mm	39,5 mm	300 mm	2,75 mm	0,6 kg
KHA 9-04F	25 mm	39,5 mm	400 mm	2,75 mm	0,8 kg
KHA 9-05F	25 mm	39,5 mm	500 mm	2,75 mm	0,9 kg
KHA 9-06F	25 mm	39,5 mm	600 mm	2,75 mm	1,2 kg
KHA 9-07F	25 mm	39,5 mm	700 mm	2,75 mm	1,4 kg
KHA 9-08F	25 mm	39,5 mm	800 mm	2,75 mm	1,6 kg
KHA 9-09F	25 mm	39,5 mm	900 mm	2,75 mm	1,8 kg
KHA 9-10F	25 mm	39,5 mm	1000 mm	2,75 mm	1,9 kg
KHA 9-11F	25 mm	39,5 mm	1100 mm	2,75 mm	2,1 kg
KHA 9-12F	25 mm	39,5 mm	1200 mm	2,75 mm	2,3 kg
KHA 9-13F	25 mm	39,5 mm	1300 mm	2,75 mm	2,4 kg
KHA 9-14F	25 mm	39,5 mm	1400 mm	2,75 mm	2,6 kg
KHA 9-15F	25 mm	39,5 mm	1500 mm	2,75 mm	2,8 kg
KHA 9-20F	25 mm	39,5 mm	2000 mm	2,75 mm	3,7 kg
KHA 9-30F	25 mm	39,5 mm	3000 mm	2,75 mm	5,6 kg
KHA 9-60F	25 mm	39,5 mm	6000 mm	2,75 mm	11,2 kg

**H:** hoogte  
**B:** breedte  
**L:** lengte



t: materiaaldikte  
G: gewicht

## DETAILS / TOEPASSINGEN

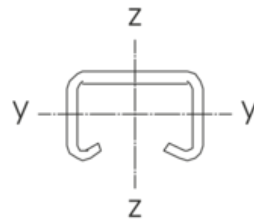
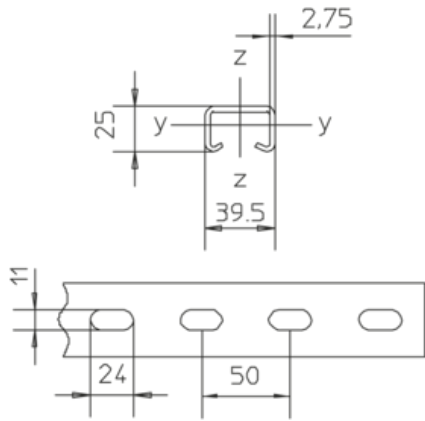

$$\begin{aligned}W_y &= 1.25 \text{ cm}^3 \\W_z &= 2.85 \text{ cm}^3 \\I_y &= 1.70 \text{ cm}^4 \\I_z &= 5.62 \text{ cm}^4\end{aligned}$$

## OPTIONELE TOEBEHOREN

AMA18, HS18, ASK 8

